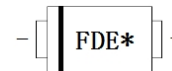

WSB5534M
1A Schottky Barrier Diode
[Http://www.sh-willsemi.com](http://www.sh-willsemi.com)
Features

- Low power loss, High efficiency
- Low forward voltage
- SMA package

SMA (DO-214AC)

Circuit

Marking
Applications

- Switching circuit
- Middle current rectification

Absolute maximum ratings

Parameter	Symbol	Value	Unit
Reverse voltage (repetitive peak)	V_{RRM}	100	V
Reverse voltage (DC)	V_R	100	V
Average rectified forward current (DC)	I_O	1.0	A
Forward Peak Surge Current ⁽¹⁾	I_{FSM}	30	A
Junction temperature	T_J	-55 ~ 150	°C
Operating temperature	T_{opr}	-55 ~ 150	°C
Storage temperature	T_{stg}	-55 ~ 150	°C

Electronics characteristics ($T_A=25^{\circ}C$)

Parameter	Symbol	Condition	Min.	Typ.	Max.	Unit
Forward voltage ⁽²⁾	V_F	$I_F=1.0A$			0.77	V
Reverse current	I_R	$V_R=100V$			100	uA
Junction capacitance	C_J	$V_R=4V, F=1MHz$		50		pF
Thermal resistance	$R_{\theta JL}$	Junction to Lead			30	K/W

Order Informations

Device	Package	Marking	Shipping
WSB5534M-2/TR	SMA (DO-214AC)	FDE* ⁽³⁾	5000/Reel&Tape

Note1: Pulse width=8.3ms, single sine pulse;

Note2: Single Pulse, test $T_p=380us$;

Note3: * =Month code (A~Z); FDE =Device code;

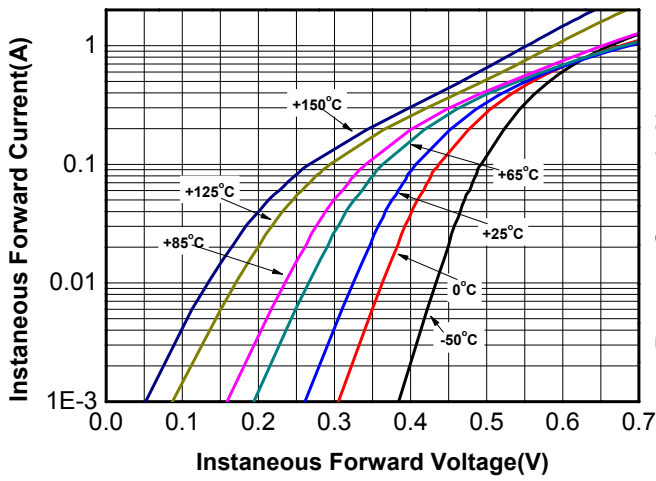
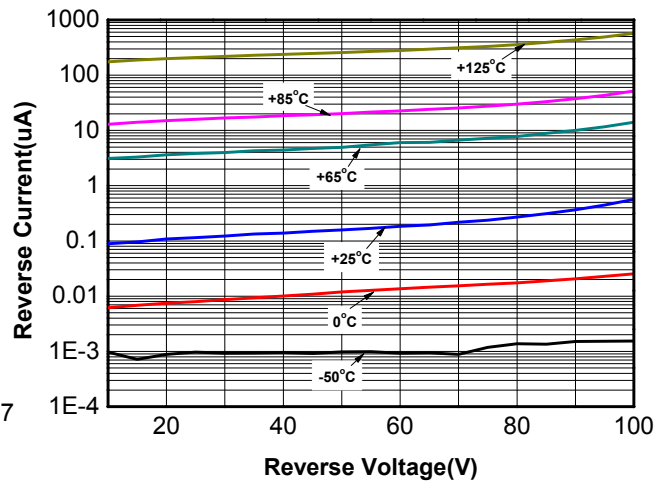
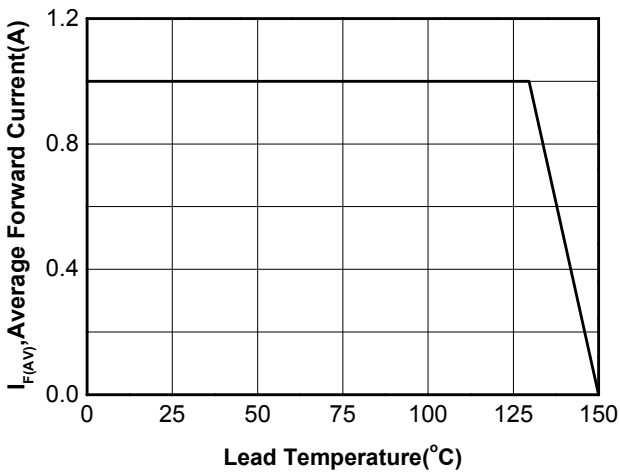
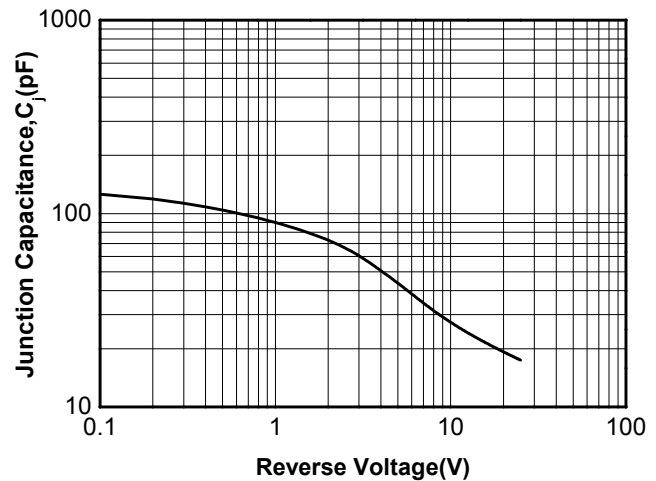
Typical characteristics (Ta=25°C, unless otherwise noted)

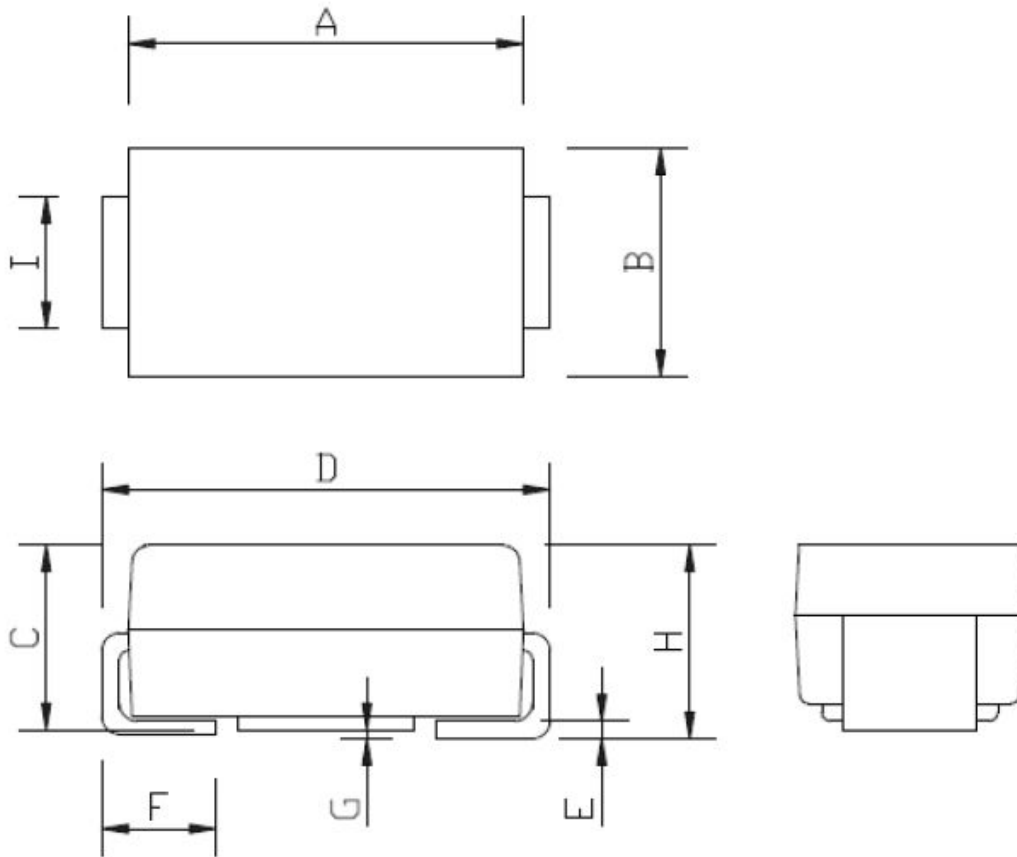
Fig.1 Forward voltage vs. Forward current

Fig.2 Reverse current vs. Reverse voltage

Fig.3 Maximum Forward Current Derating Curve

Fig.4 Junction capacitance vs. Reverse voltage

Package outline dimensions
SMA (DO-214AC)

Symbol	Dimensions in millimeter	
	Min.	Max.
A	4.25	4.65
B	2.40	2.80
C	1.85	2.15
D	4.85	5.35
E	0.10	0.30
F	0.90	1.50
G	0.20 Max.	
H	1.90	2.30
I	1.35	1.65